

## FRONT SUSPENSION

# SHOCK ABSORBERS

### REMOVAL

1. Activate the parking lock, raise the car at the front, secure it onto safety stands and remove the wheel.
2. Unscrew the lock nut ① and nut ② securing the shock absorber ③ at the top to the bodywork.
3. Unscrew the nut ⑤ securing the lower wishbone ④ and slide out the shock absorber, retrieving the lower washers and upper buffers.

- |                  |                  |
|------------------|------------------|
| 1 Lock nut       | 4 Lower wishbone |
| 2 Nut            | 5 Nut            |
| 3 Shock absorber |                  |

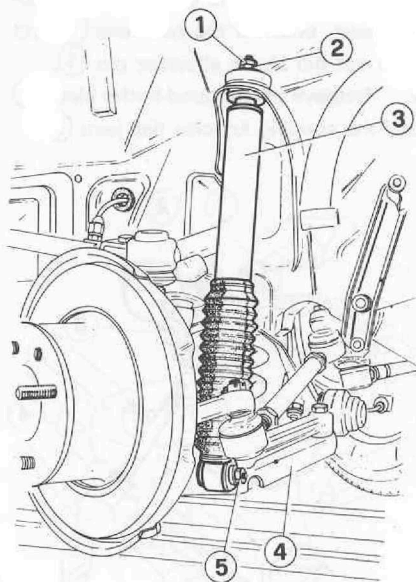

### INSTALLATION

Proceed by carrying out removal operations in reverse order.

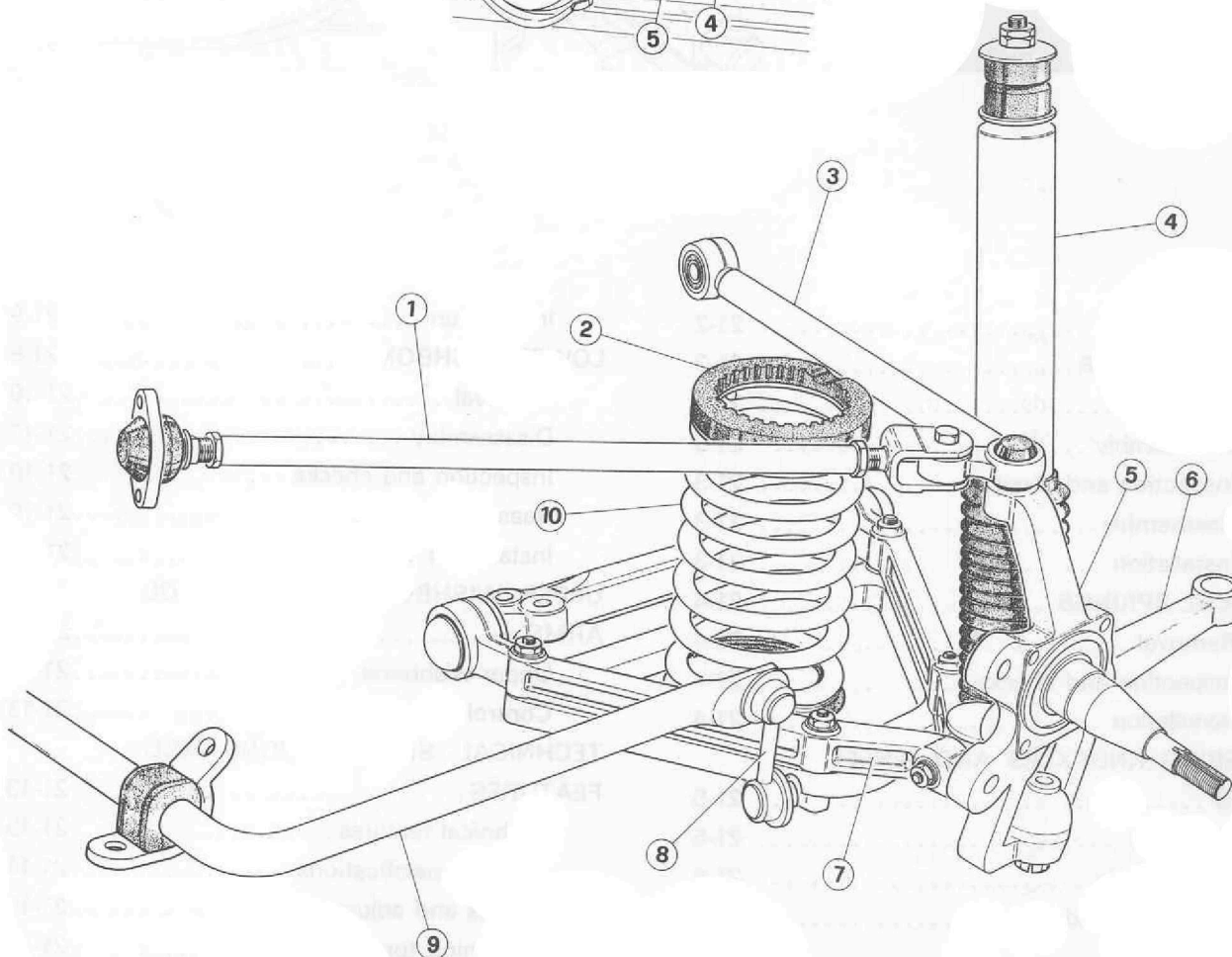

- |                    |                           |
|--------------------|---------------------------|
| 1 Control arm      | 6 Steering lever          |
| 2 Spring washer    | 7 Lower wishbone          |
| 3 Upper wishbone   | 8 Stabilizer bar link rod |
| 4 Shock absorber   | 9 Stabilizer bar          |
| 5 Steering knuckle | 10 Spring                 |